

CLAMPS

SINGLE - STANDARD IN POLYPROPYLENE

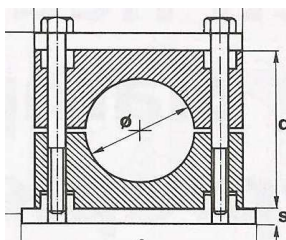

GROUP	TUBE BORE	PART NO COMPLETE					
			COMPLETE	BODY PAIR	WELD PLATE	COVER PLATE	BOLT EACH
1	6	HCS-106L					
	6.4	HCS-106.4L					
	8	HCS-108L					
	9.5	HCS-109.5L	3.10	0.95	1.36	0.40	0.19
	10	HCS-110L					
	12	HCS-112L					
2	12.7	HCS-212.7L					
	13.5	HCS-213.5L					
	14	HCS-214L					
	15	HCS-215L					
	16	HCS-216L	3.29	1.02	1.46	0.42	0.19
	17.2	HCS-217.2					
3	18	HCS-218L					
	19	HCS-319L					
	20	HCS-320L					
	21.3	HCS-321.3L					
	22	HCS-322L	3.73	1.26	1.58	0.49	0.20
	23	HCS-323L					
4	25	HCS-325L					
	26.9	HCS-426.9L					
	28	HCS-428L	4.34	1.57	1.79	0.55	0.21
	30	HCS-430L					
	32	HCS-532L					
	33.7	HCS-533.7L					
5	35	HCS-535L					
	38	HCS-538L	5.16	2.40	1.65	0.63	0.24
	40	HCS-540L					
	42	HCS-542L					
	44.5	HCS-644.5L					
	45	HCS-645L					
6	48	HCS-648L	P.O.A.	P.O.A.	P.O.A.	P.O.A.	P.O.A.
	50	HCS-650L					
	52	HCS-652L					