

CLAMPS

SINGLE - HEAVY IN POLYPROPYLENE

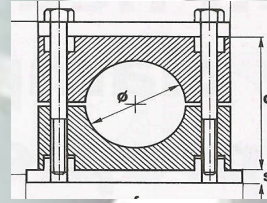

GROUP	TUBE BORE	PART NO COMPLETE					
			COMPLETE	PAIR (RCPR)	PLATE (AP-C)	PLATE (DP-C)	EACH (SS-C)
1	6	HCS-106H	11.95	3.36	5.49	2.25	0.45
	6.4	HCS-106.4H					
	8	HCS-108H	11.95	3.36	5.49	2.25	0.45
	9.5	HCS-109.5H					
	10	HCS-110H	11.95	3.36	5.49	2.25	0.45
	12	HCS-112H	11.95	3.36	5.49	2.25	0.45
	12.7	HCS-112.7H	11.95	3.36	5.49	2.25	0.45
	13.5	HCS-113.5H					
	14	HCS-114H					
	15	HCS-115H	11.95	3.36	5.49	2.25	0.45
2	16	HCS-116H	11.95	3.36	5.49	2.25	0.45
	17.2	HCS-117.2H					
	18	HCS-118H	11.95	3.36	5.49	2.25	0.45
	19	HCS-219H	14.34	4.31	6.31	2.38	0.69
	20	HCS-220H	14.34	4.31	6.31	2.38	0.69
	21.3	HCS-221.3H					
	22	HCS-222H	14.34	4.31	6.31	2.38	0.69
	23	HCS-223H					
	25	HCS-225H	14.34	4.31	6.31	2.38	0.69
	26.9	HCS-226.9H					
3	28	HCS-228H	14.34	4.31	6.31	2.38	0.69
	30	HCS-230H	14.34	4.31	6.31	2.38	0.69
	32	HCS-332H	17.38	6.16	6.84	2.91	0.75
	33.7	HCS-333.7H	17.38	6.16	6.84	2.91	0.75
	35	HCS-335H	17.38	6.16	6.84	2.91	0.75
	38	HCS-338H	17.38	6.16	6.84	2.91	0.75
	40	HCS-340H					
	42	HCS-342H	17.38	6.16	6.84	2.91	0.75
	44.5	HCS-444.5H					
	45	HCS-445H					
4	48	HCS-448H	39.46	12.17	16.62	6.16	2.27
	50	HCS-450H					
	52	HCS4652H					